

제품 소개

- ULB 인장 및 압축 로드셀은 100kg ~ 5000kg 까지의 다양한 용량의 제품이 있습니다.
- Stainless Steel로 제작 되었으며 컴파운드 포팅되어 환경적으로 완전히 밀봉된 구조입니다.
- ULB 모델은 견고하며 공정 플랜트 응용 분야에서 경제적인 가격으로 사용할수 있습니다.
- 제품은 OIML 과 NTEP 승인을 받은 제품입니다.

특징 Feature

- Stainless Steel 구조 / 밀폐 봉인 구조
- 인장, 압축 겸용 / 높은 정밀도 / 다양한 용량
- EN 60 529에 따른 보호 : IP 67
- 로드셀 케이블 : 폴리 우레탄 6m × 5mm

specifications

	kg	100 / 200 / 500 / 1,000 / 2,000 / 3,000 / 5,000	100 / 200	500 / 1,000 / 2,000 / 3,000 / 5,000
Maximum capacity (E _{max})	kg	100 / 200 / 500 / 1,000 / 2,000 / 3,000 / 5,000	100 / 200	500 / 1,000 / 2,000 / 3,000 / 5,000
Minimum dead load (E _{min})	%*E _{max}	0		
Accuracy class according to OIML R60		(GP)	G3**	C3*
Maximum number of verification intervals (n _{max})		n.a.	3,000	
Minimum load cell verification interval (v _{min})		n.a.	E _{max} / 12,000	
Temperature effect on minimum dead load output (TC ₀)	%*RO/10°C	± 0.0400	± 0.0116	
Temperature effect on sensitivity (TC _{RO})	%*RO/10°C	± 0.0200	± 0.0100	
Combined error	%*RO	± 0.0500	± 0.0200	
Non-linearity	%*RO	± 0.0400	± 0.0166	
Hysteresis	%*RO	± 0.0400	± 0.0166	
Creep error (30 minutes) / DR	%*RO	± 0.0600	± 0.0166	
Rated Output (RO)	mV/V	2 ± 0.1%		
Calibration in mV/V/W (A...I classified)	%	± 0.05 (± 0.005)		
Zero balance	%*RO	± 5		
Excitation voltage	V	5...15		
Input resistance (R _{ic})	Ω	1,100 ± 50		
Output resistance (R _{out})	Ω	1,000 ± 2		
Insulation resistance (100 V DC)	MΩ	≥ 5,000		
Safe load limit (E _{lim})	%*E _{max}	200		
Ultimate load	%*E _{max}	300		
Compensated temperature range	°C	-10...+40		
Operating temperature range	°C	-20...+65 (ATEX -20...+60)		
Load cell material		stainless steel 17-4 PH (1.4548)		
Sealing		potted		
Protection according EN 60 529		IP67		
Packet weight	kg	1.0 (100kg, 200kg), 1.1 (500kg, 1,000kg), 1.85 (2,000kg), 2.62 (3,000kg), 5.22 (5,000kg)		

* Accuracy class is only valid for tension load. ** corresponds to C3 quality, test certificate not available
 The limits for Non-Linearity, Hysteresis, and TC_{RO} are typical values.
 The sum of Non-linearity, Hysteresis and TC_{RO} meets the requirements according to OIML R60 with p_{ic}=0.7.

product dimensions (mm)

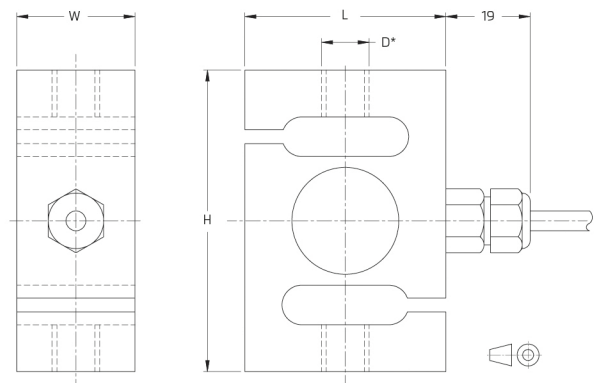

Type	H	L	W	Metric thread D-M	Unified thread D-U	Unified thread D-H
100 kg...500 kg	76.2	49	30	M12	1/2-20	5/8-18
1000 kg				M16		
2000 kg	86.1	76.2			5/8-18	
3000 kg	88.7	88.7	40	M20 x 1.5	3/4-16	
5000 kg	146	91.2	56.4	M24 x 2	1-12	

* 3 versions available: ULB-xxxx kg-M (with metric thread), ULB-xxxx kg-U (with unified thread) or ULB-xxxx kg-H (with special thread)

wiring

The load cell is provided with a shielded, 4 conductor cable (AWG 24).

Cable jacket: polyurethane

Cable length: 6 m

Cable diameter: 5 mm

The shield is floating (On request the shield can be connected to the load cell body)

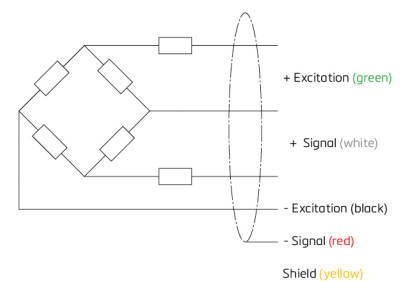

RoHS compliant

